

Desk Series

User Guide



www.ingenico.us

Ingenico USA
3025 Winward Plaza
Suite 600
Alpharetta, Georgia 30005 - USA

1_Unpacking

According to the model, the following items are included in the packaging box (including optional accessories):

- The terminal equipped with its paper roll
- The power supply with its cable connection (according to the national needs).
- The cable connection for the telephone or Ethernet network This installation guide

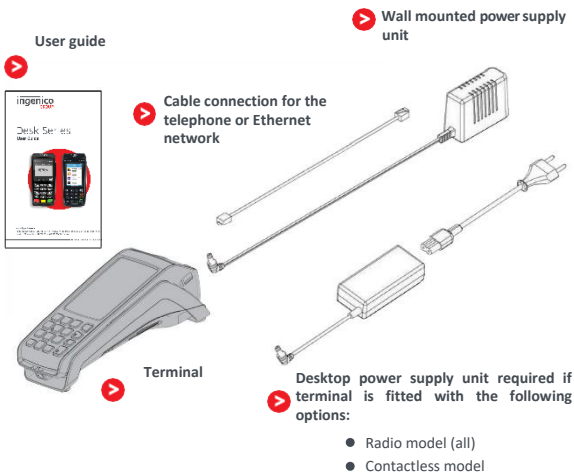

CAUTION

The power supply unit provided with your equipment is specially designed for it. Do not use any other power supply.

2_ Installation

2_1 Positioning the terminal

Install the terminal on a flat surface, with an easy access to an electrical outlet and telephone line. Place the terminal away from any heat source and protected from dust, vibrations and electromagnetic radiations (away from video terminals, PC, anti-shoplifting barriers, ...). The terminal is exclusively made for indoor use.

Operating conditions

Ambient temperature	from 0°C to +40°C / 32°F to 104°F
Max relative humidity	85% at +40°C / 104°F
Max altitude	2000 m /

Storage conditions

Storage temperature	-20°C to 55°C / -4°F to 131°F
Max relative humidity	85% at +55°C / 131°F

3_1 Connections

All connections are on the rear of the terminal protected by a down-side trapdoor.

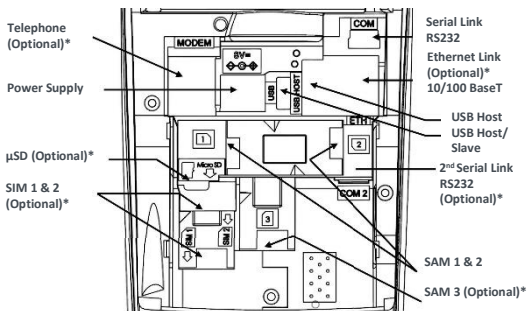

*according to the model

Phone: TNV-3.

Power Supply: Limited Power Source.

Other connections: Safety Extra-low Voltage. According to IEC60950-1 and EN60950-1

4_1 Installing the Terminal - Cable fixing

Opening down-side trapdoor

Unclip the trapdoor by pushing on the clip **1** with your finger as shown on the figure here below.

Then lift the trapdoor rearward to remove it, as shown by arrows **2** on the figure

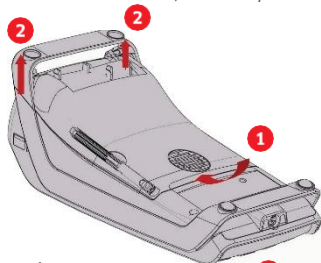

Closing down-side trapdoor

To close the trapdoor, start by landing trapdoor on to bottom casing as shown on the figure **1**, manage 5/6mm distance **2** for clip insertion then push **3** and clip it.

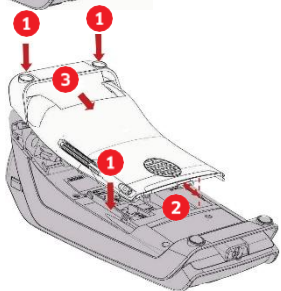

Connecting cables



WARNING

Connecting is to be made when the terminal is powered off.

Perform the following operations :

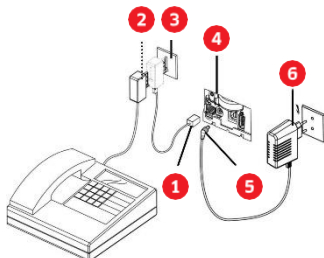

- Open down-side trapdoor
- Plug telephone line **1** with user country specific converter **2** to the telephone network. **3** Connect the other end to the terminal telephone connection. **4**
- If necessary, connect the telephone (not required for terminal to operate).
- Optionally plug other cables into the appropriate ports (Ethernet, RS232, USB...)
- Plug PSU **6** power lead **5** into the power socket **4**.



- Close down-side trapdoor
- Plug the power supply into the mains.

For instance, possible configuration for France

(*): TNV-3 circuit: Telecommunication Network Voltage, as per safety standard EN 60950-1.

4_2_1 Kit Magic Box installation (optional)



WARNING

Connecting is to be made when the terminal is powered off.

Perform operations as described in “connecting cables” chapter and connect cables as follow:

- Cables to plug:

- 1 Power lead
- 2 Telephone line
- 3 Ethernet cable
- 4 Serial link RS232 cable

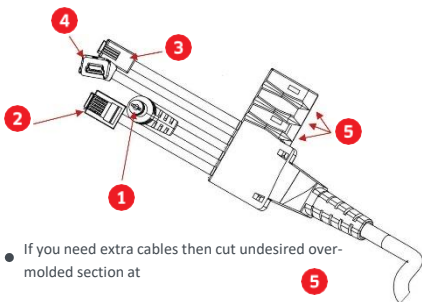

- If you need extra cables then cut undesired over-molded section at 5
- Install through-holes in the lead-through guides (as indicated on the figure).

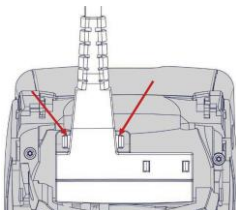

• SEAMLESS PAYMENT



ADVICE

It is strongly recommended to secure the “Magic cable” to terminal’s work area in order to reduce stress on terminal and connection.

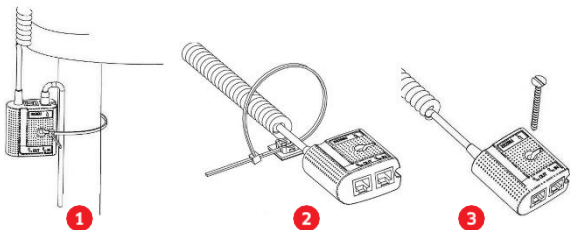

- 1** Using the supplied cable tie to attach to a table leg (or similar)
- 2** Using the supplied cable tie and self-adhesive support
- 3** Using a counter-sunk screw (not supplied) to an appropriate surface

The “Magic Cable” should be readily accessible for terminal maintenance and helpdesk diagnosis purposes.



NOTE:

The connection Magic Box can also be attached using a VELCRO™ or other system.

5_Installing a paper roll

Your terminal is supplied with one paper roll. When the paper roll is nearing the end, a red line will appear on the paper; this indicates that the paper roll must be replaced.



CAUTION

Use only paper approved by the manufacturer (diameter 40 mm). Use of unsuitable paper is likely to damage the printer of your terminal (see paper characteristics at "Maintenance" chapter).

- Open the paper compartment by lifting the catch located at the rear of the terminal and drag the cover to the rear.

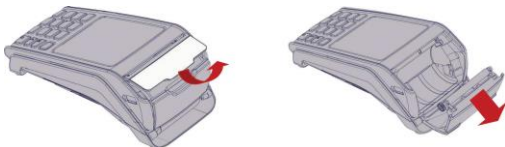

CAUTION

Do not force the cover against the cables.

- Insert the paper roll in the compartment following the directions shown on the figure below.
- Pull the paper up to the top of the terminal and hold it in this position.
- Maintain the paper and close the lid.
- Press the top of the lid in the center as shown by arrow, until it clips into position.



ADVICE

If you are inserting a new paper roll remove the first complete turn (this first turn of sensitive surface could be damaged during shipment).

6_Daily use



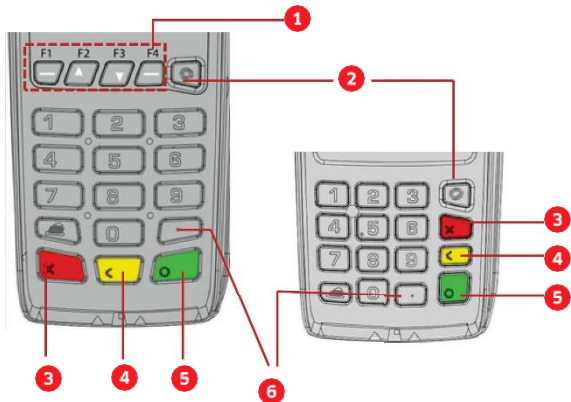

6_1 Keypad functions



- 1** NAVIGATION keys
- 2** Ingenico key
- 3** CANCEL key (red)
- 4** CLEAR key (yellow) / Feed paper (long press) **5**
- VALIDATION key (green)
- 6** Dot key

6_2 Adjusting the contrast (B&W display only)

No contrast management for the Color display

If you wish to increase or to decrease the contrast of the characters displayed on screen, press simultaneously on the  (dot key) and  key to decrease the contrast, or the  (dot key) and  key to increase it. Keep pressing the keys as long as necessary.

6_3 Card insertion

6_3_1 Swiping a card

- Insert the card manually in the driver, magstripe facing the main body of the terminal.



Swipe the card with constant speed, not too slowly not too fast, to maximize the reading efficiency and avoid annoying repetitions.

6_3_2 Inserting a chip card

- Chip Cards should be inserted into your terminal as illustrated with the chip facing up and into the card reader.



6_3_3 Reading Contactless (Optional)

- Bring the card firmly up to the active zone above (at about 1cm) the contactless logo located on paper trapdoor button.
- Keep the card close to the contactless logo during the transaction
- Your contactless terminal provides four contactless status lights located on display/ lens.

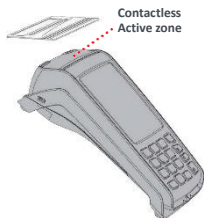

- When a contactless transaction is started the first (left hand) status light will be lit steadily; this indicates that the contactless is in use, but a card is not being read.
- When a contactless card is presented to the contactless active zone (*) during a transaction the second, third and fourth status lights will be lit in turn. The card read is successful when all four status lights are lit and a confirmation tone can be heard.

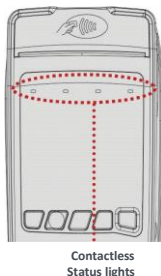

(*): Contactless Symbol is a trademark owned by and used with the permission of EMVCo, LLC.



CAUTION

Do not stick any conductive label on to contactless active zone located on paper trapdoor button. It can decrease seriously contactless efficiency.

6_3_4 Headphone output (Optional)

- The headphone output jack is located under the card reader outlet. This option is not designed to play music, but to facilitate the use by blind people.